

LJ575

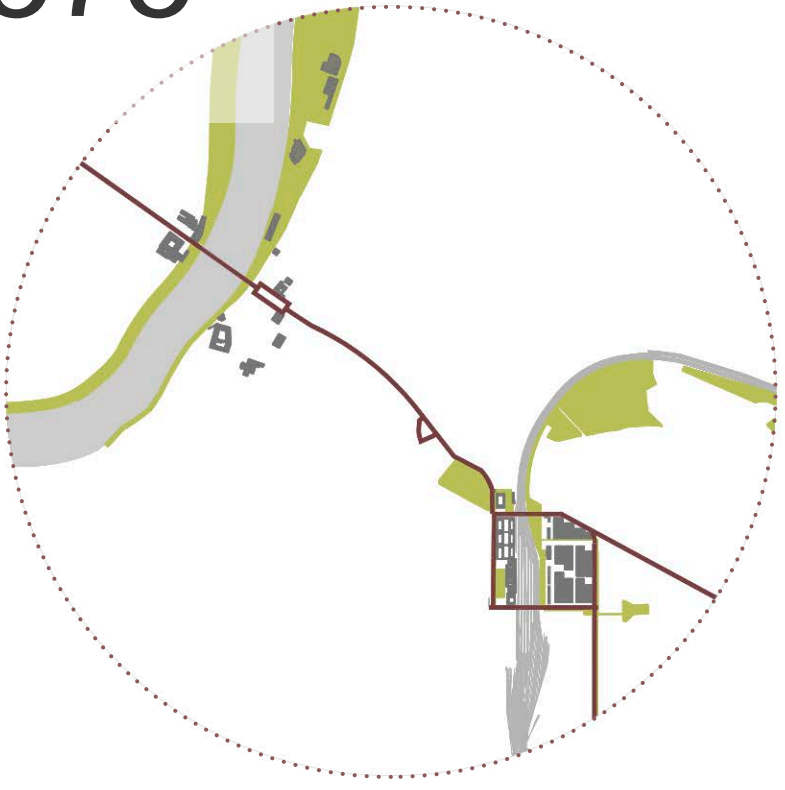

FROM CULTURAL TO PRODUCTIVE AXIS

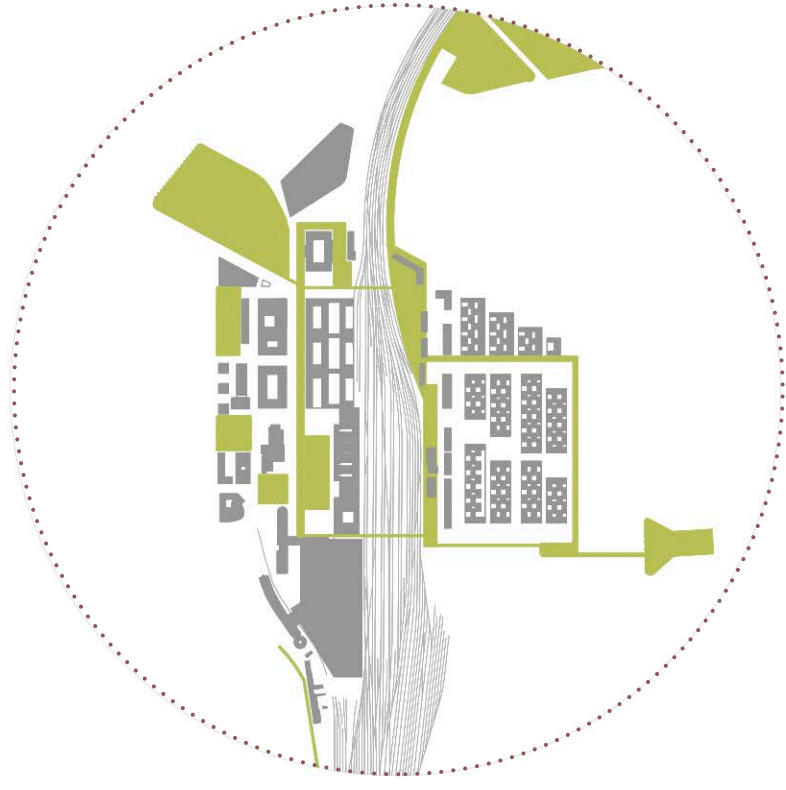

GREEN CONNECTORS

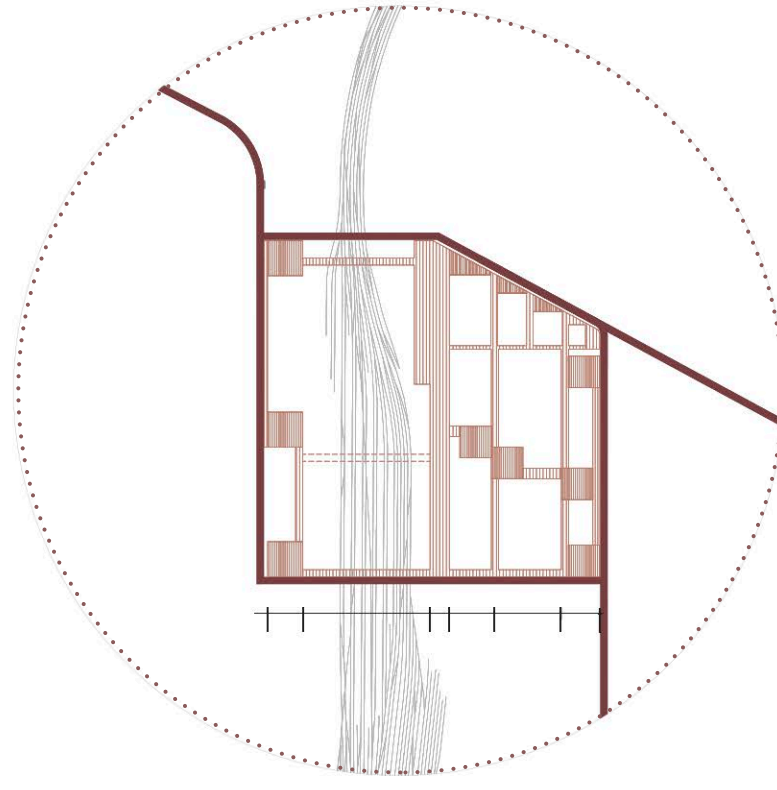

URBAN SPACE CONTINUITY

- pedestrian pathway
- covered pedestrian pathway
- pedestrian trail
- bicycle lane
- bus stop
- underground station
- exterior parking
- indoors parking

The challenge for Linz's main-station area lies in defining a new urban centrality with enough structural coherence and symbolic identity to become a recognisable city landmark. Our project envisages a multifunctional hub that rescues the memory of Linz's industrial heritage and combines a high-density solution with a gentle human scale based on an appealing indoor/outdoor articulation.

The station surroundings lack a recognisable character: disparate urban fabrics reach the limits of the ÖBB site without establishing any conscious dialogue between each other. At a city scale, our proposal aims to provide a comprehensive order to these centripetal forces, understanding the study site (and beyond) as a series of parallel urban stripes with different yet intertwined personalities. In order to bring closer both sides of the railways and to increase the accessibility from the surrounding neighbourhoods, a series of strategic linear connections, public squares and green areas are established throughout this succession of stripes.

1:2000 0 10 50 100

