

FAB LINZ - ARCHITECTURAL URBAN STRATEGY

FABLINZ masterplan is designed with the guidance of three main Architectural Urban Tools. The aim is to set a design strategy, which could be used for the expansion of FABLINZ into the Strategic Site and for further developments within the city of Linz. These three **Architectural Urban Tools** are the Urban Surfaces, the Productive Blocks and the Living-Working Units. The **Urban Surfaces** define multifaceted public spaces whose aim is to attract potential new users and visitors of the FABLINZ. Different typologies of spaces correspond to different users needs. The **Productive Blocks** are modular double height volumes, which can be easily subdivided into smaller units offering flexible and adaptable spaces. The ground floor access and the scale of the intervention aim to stimulate the synergies between different activities, residents, users and visitors. The **Living-Working Units** are cantilevered volumes starting from the second floor with a maximum height of five storeys. They are designed to host a number of different functions and can be easily converted from one to the other. The project identifies also a special element, the Bridge building, whose main function in to convey potential users and visitors to the FABLINZ and to connect it with the rest of the city overcoming the railways. This building works as a catalyst of the development and hosts a number of new functions completing the rest of the masterplan.

LIVING-WORKING UNITS

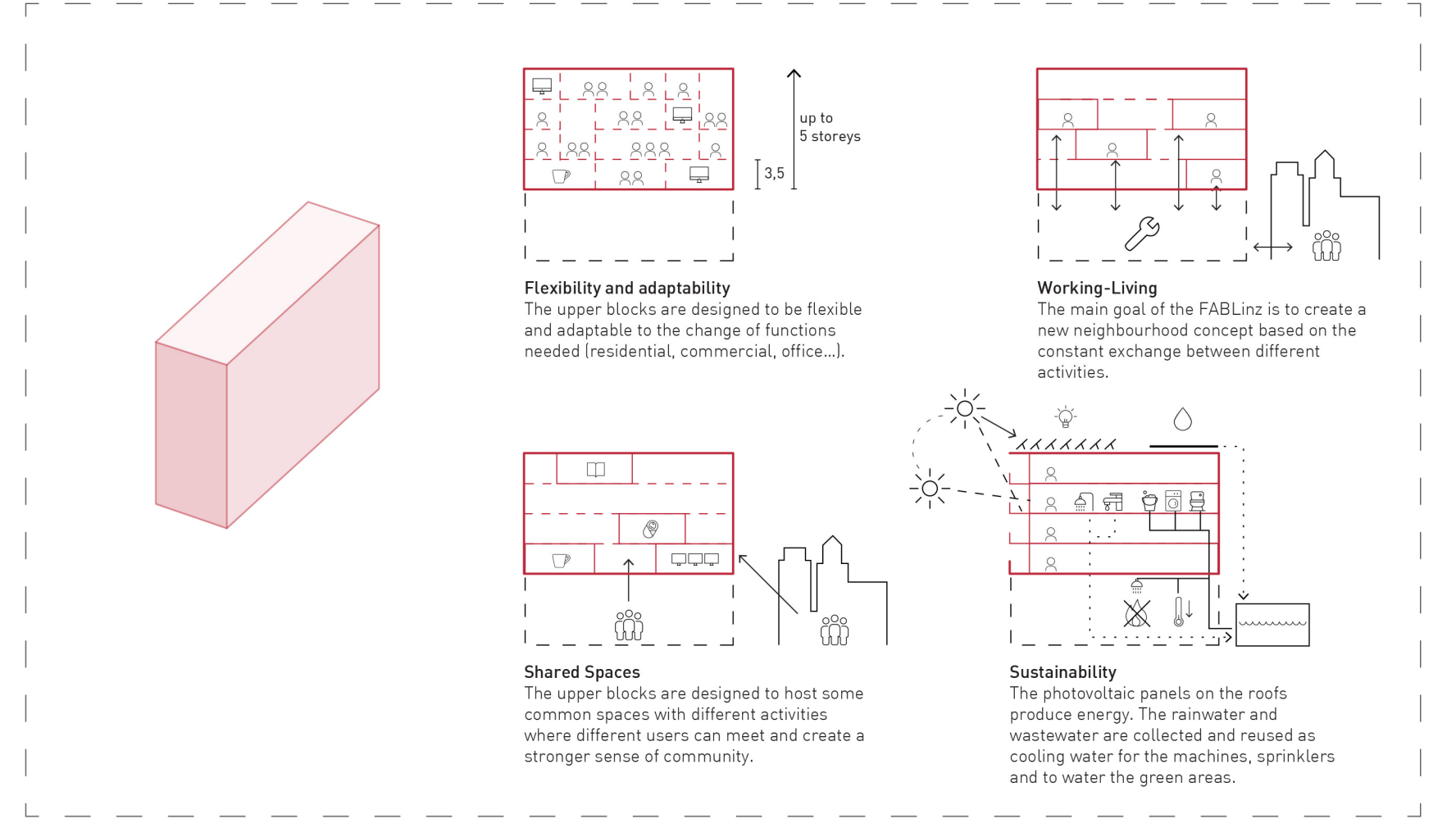

PRODUCTIVE BLOCKS

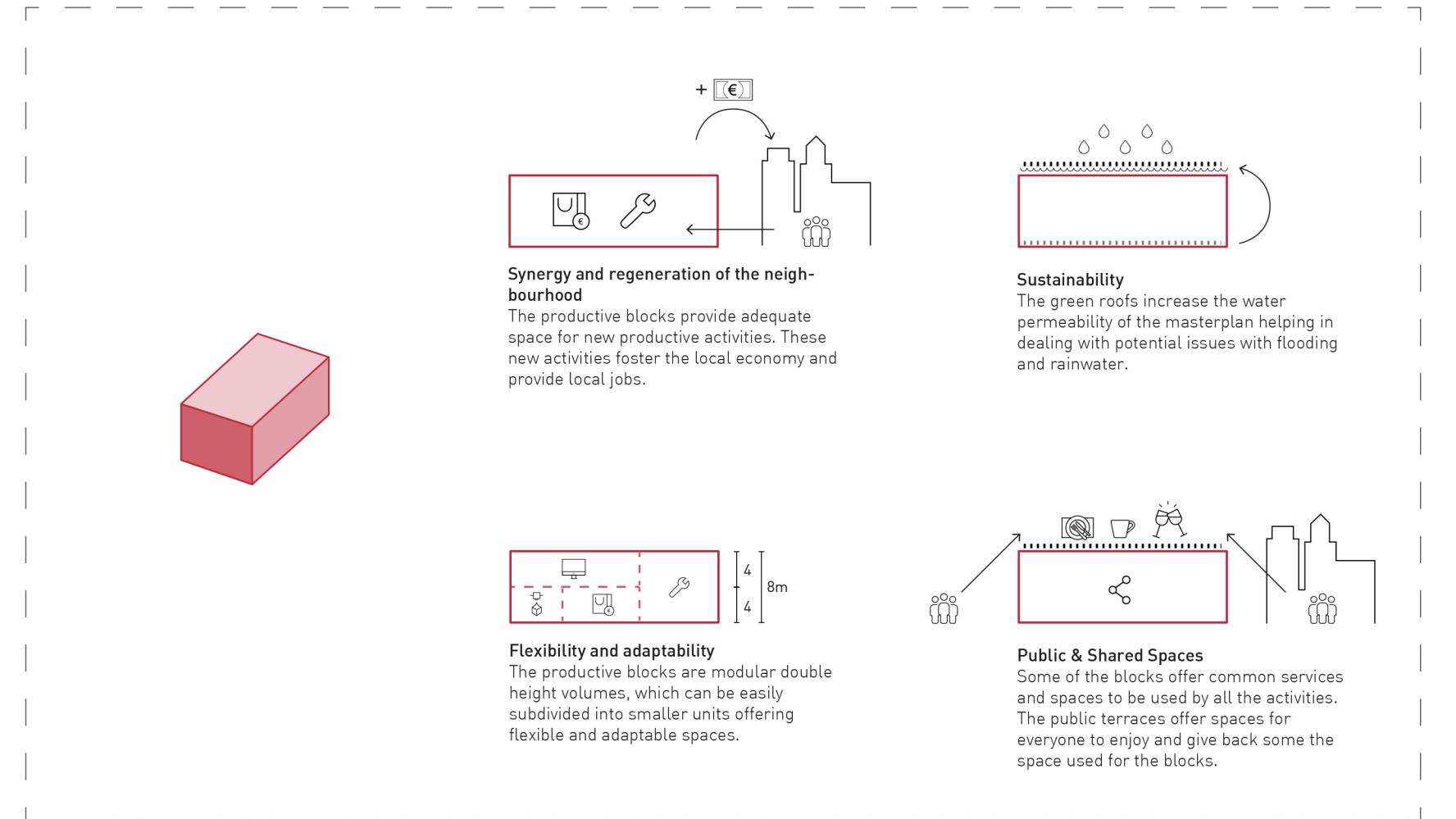

URBAN SURFACES

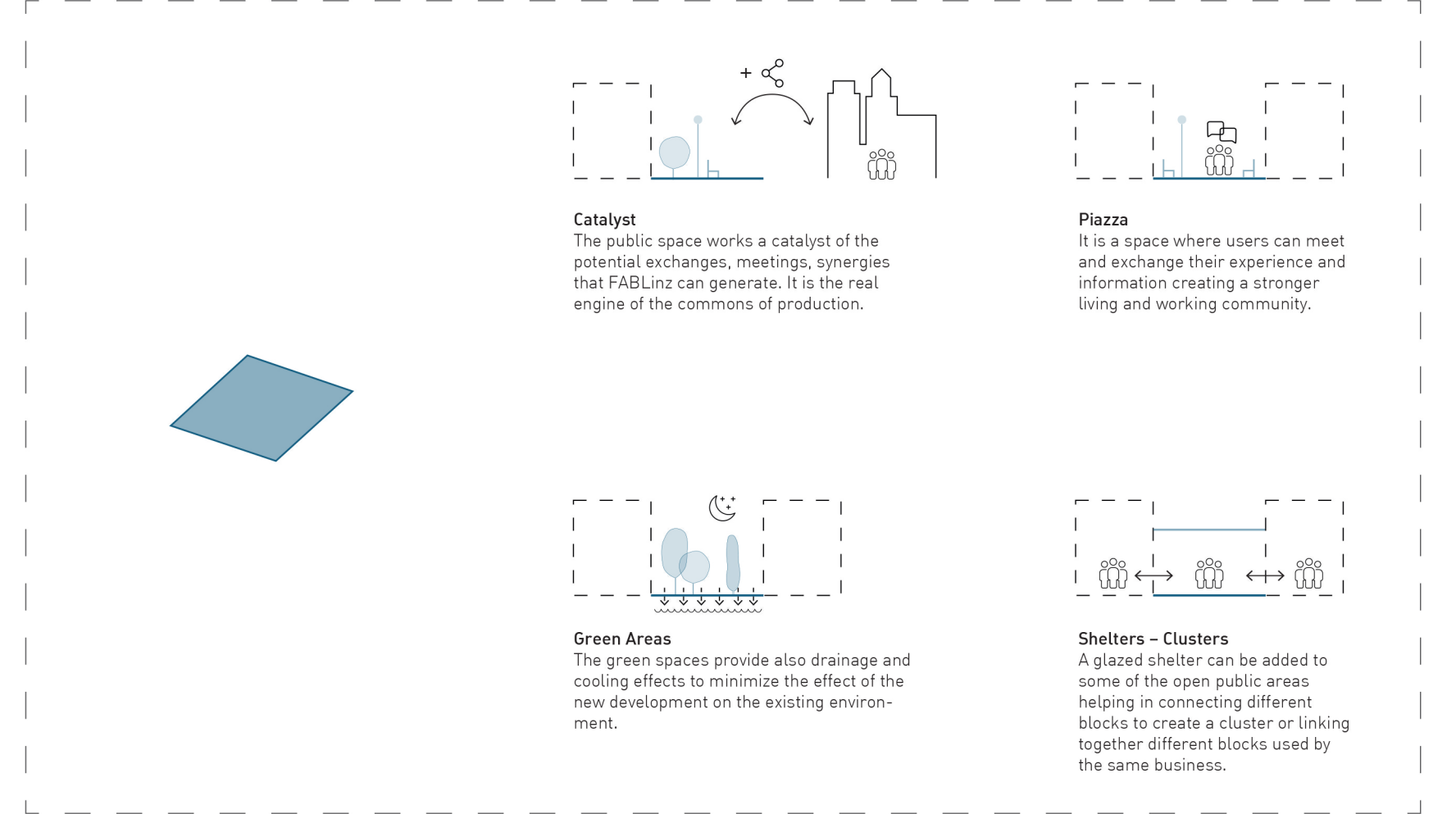

The Bridge Building Section Diagram

